

# Ø 16 mm Pilot Lights



## L16RR Series CATALOG



For your safety, read and follow the considerations written in the instruction manual, other manuals and Autonics website.

The specifications, dimensions, etc. are subject to change without notice for product improvement. Some models may be discontinued without notice.



### Features

- Compact, space-saving 16 mm installation diameter
- Short rear-length size of only 29.5 mm

### Specifications

<b>Series</b>	<b>L16RR Series</b>
<b>Installation</b>	Extended
<b>Shock</b>	500 m/s <sup>2</sup> (≈ 30 G) in each X, Y, Z direction for 3 times
<b>Shock (malfunction)</b>	100 m/s <sup>2</sup> (≈ 10 G) in each X, Y, Z direction for 3 times
<b>Vibration</b>	1.5 mm amplitude at frequency of 10 to 55 Hz (for 1 min) in each X, Y, Z direction for 2 hours
<b>Vibration (malfunction)</b>	1.5 mm amplitude at frequency of 10 to 55 Hz (for 1 min) in each X, Y, Z direction for 10 minutes
<b>Ambient temperature</b>	-15 to 55 °C, storage: -25 to 65 °C (no freezing or condensation)
<b>Ambient humidity</b>	35 to 85 %RH, storage: 35 to 85 %RH (no freezing or condensation)
<b>Protection structure</b>	Light unit: IP65 (IEC standard)
<b>Approval</b>	CE <sup>(01)</sup>  
<b>Light unit weight</b>	≈ 11.5 g
<b>Housing weight</b>	≈ 1.4 g

01) IEC-60947-5-1

<b>LED blocks</b>	
Rated voltage	5 / 12 / 24 VDC== model
Current consumption	Refer to the below Current consumption table.
Approval	CE <sup>(01)</sup>  
Weight	≈ 1.9 g

Current consumption	Red	Blue	Green	Yellow	White
<b>SA16-L5□ (5 VDC==)</b>	6 to 9 mA	10 to 14 mA	5 to 7 mA	12 to 16 mA	10 to 14 mA
<b>SA16-L12□ (12 VDC==)</b>	9 to 14 mA	10 to 15 mA	5 to 9 mA	10 to 16 mA	9 to 14 mA
<b>SA16-L24□ (24 VDC==)</b>	15 to 20 mA	20 to 26 mA	16 to 22 mA	27 to 35 mA	23 to 30 mA

### Sold Separately

- LED blocks (SA□-L□□□)
- Locking handle (SA□-LH)

## Ordering Information

This is only for reference. For selecting the specified model, follow the Autonics website.

Model is based on light unit+block combination. Light units or blocks are sold separately. In case of block, refer to control switch accessories.

<b>L16RR</b>	<b>①</b>	-	<b>②</b>	<b>③</b>	<b>④</b>
	Light unit				Block

### ① Appearance

No mark: Round  
S: Square  
T: Rectangular

### ③ Button color

R: Red  
B: Blue  
G: Green  
Y: Yellow  
W: White

### ② Guard type

E: None (extended, round)  
H: Half guard (square / rectangular)

### ④ LED block

5: 5 VDC=  
12: 12 VDC=  
24: 24 VDC=

Model	Contact block	LED block
	C contact	DC voltage
L16RR-E□5		1 (5 VDC=)
L16RR-E□12	-	1 (12 VDC=)
L16RR-E□24		1 (24 VDC=)
L16RRS-H□5		1 (5 VDC=)
L16RRS-H□12	-	1 (12 VDC=)
L16RRS-H□24		1 (24 VDC=)
L16RRT-H□5		1 (5 VDC=)
L16RRT-H□12	-	1 (12 VDC=)
L16RRT-H□24		1 (24 VDC=)

## Dimensions

• Unit: mm, For the detailed drawings, follow the Autonics website.

• Panel thickness: ≤ 3.5 mm

### ■ L16RR-E □ (extended, round)

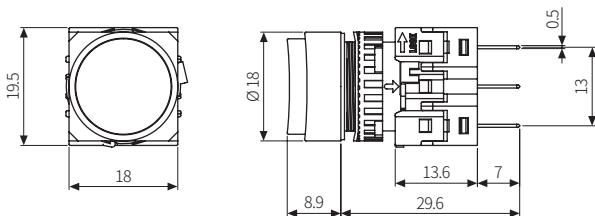

### ■ L16RRS-H □ (square, half guard)

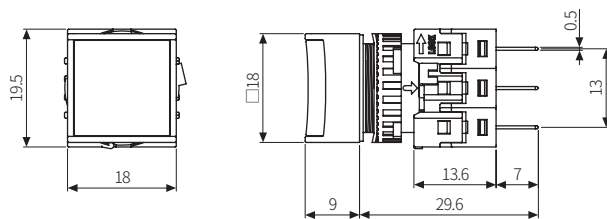

### ■ L16RRT-H □ (rectangular, half guard)

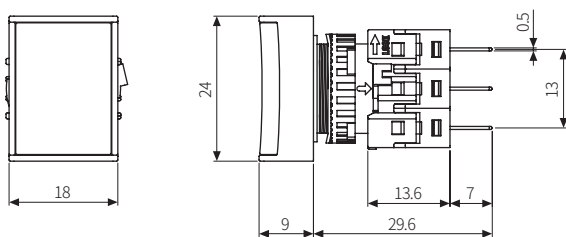

### ■ Terminal pin

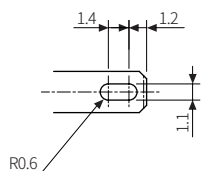

### ■ Panel cut-out

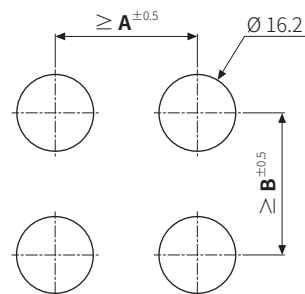

	A	B
Round	20	21
Square	20	21
Rectangular	25	21